

TOMB RAIDER EXPERIENCE — SEATTLE —

TombRaiderSeattle.com

Presented by
HOURGLASS ATTRACTIONS

OUR MISSION

Far beyond traditional "escape room" offerings, **The Tomb Raider Experience Seattle: Escape from the Temple of Fire** is a truly unique entertainment experience. Designed as "An Action Adventure for Everyone," this experience will promote interaction among players of varying ages, abilities, and skill levels, making it a perfect choice for outings with families, friends, and coworkers.

ABOUT US

Seth Wolfson is the Owner and Creative Director of Hourglass Escapes and Co-Owner of Hourglass Attractions. Seth has worked in the film and theme park industries since 1988, including as a scenic and animatronic artist for Universal Studios, and has been designing and operating award-winning escape room experiences and video games since 2016.

Loren L. Coleman is the Co-Owner of Hourglass Attractions and CEO-Owner of Catalyst Game Labs. In addition to his work in the gaming industry, Loren is a bestselling author of more than twenty novels. He has worked on award-winning miniatures games and roleplaying properties, record breaking crowd funding projects, and has scripted several video games for companies such as Microsoft and Zipper Interactive.



The Tomb Raider Experience Seattle: Escape from the Temple of Fire © 2024 Hourglass Attractions, LLC. Hourglass Escapes™. TOMB RAIDER © Crystal Dynamics group of companies. All rights reserved. TOMB RAIDER, LARA CROFT, CRYSTAL DYNAMICS, and the CRYSTAL DYNAMICS logo are trademarks of the Crystal Dynamics group of companies.

IMMERSE YOURSELF IN THE WORLD OF TOMB RAIDER

Artist Rendition. All features subject to change or removal.

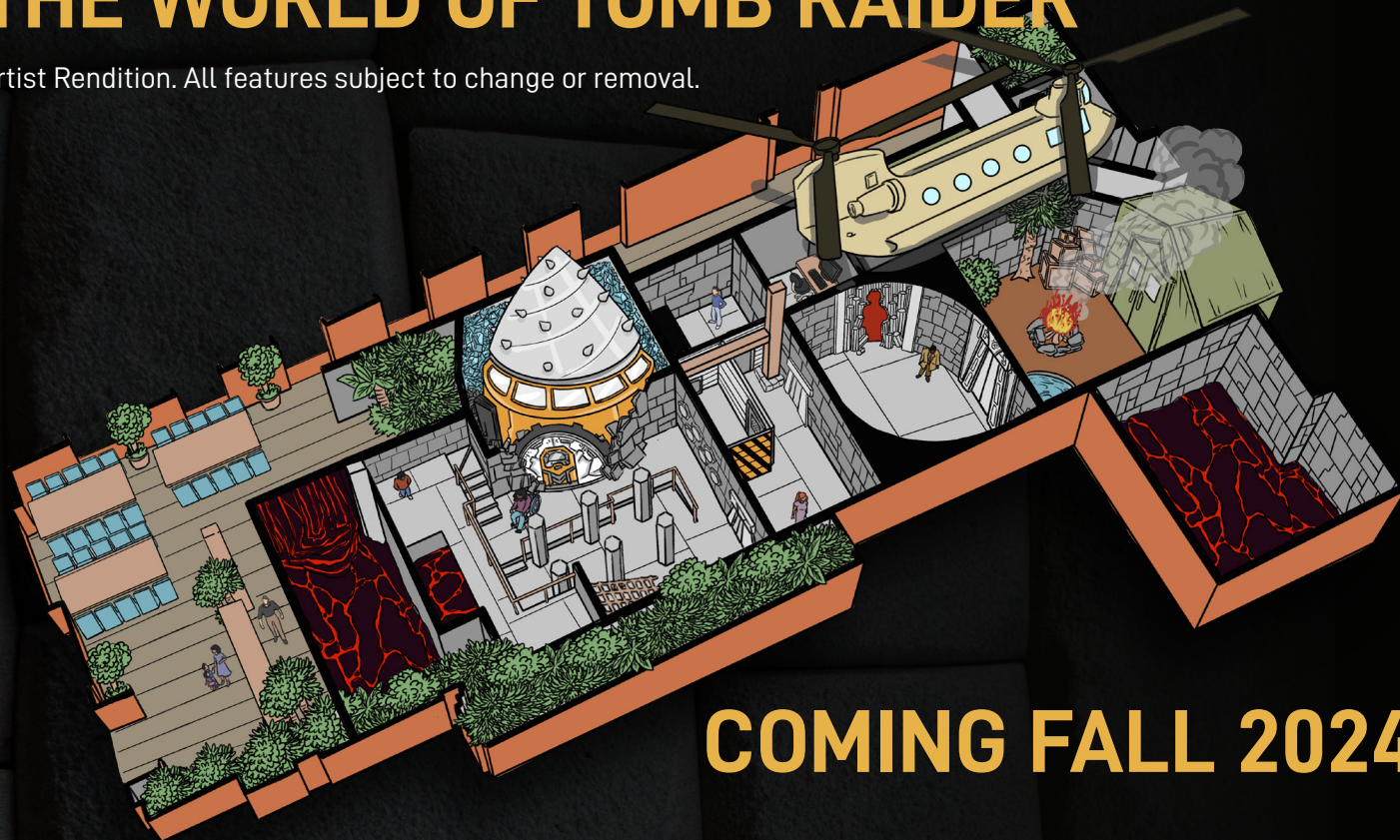

DIGITAL PRESS KIT:



Contains:

- Official Press Release, full text
- Experience Logo
- Perspective Rendering
- Poster Design
- Hourglass Attractions Logo

COMING FALL 2024

The Tomb Raider Experience Seattle: Escape from The Temple of Fire, an official Tomb Raider experience that features extraordinary landscapes, heart-thumping adventures, challenging puzzles, and live actors all working together to bring the Tomb Raider world to life. 90+ minutes of pulse-racing action, culminating in a thrilling, lava-soaked finale.

EXPERIENCE SPECS

- Time: 90+ minutes
- Size: Multi-Room
- Team Size: 1-10 players
- Up to 30 players per time slot
- Public Booking
- Wheelchair accessible
- Event Space
- Gift Shop and Exclusive Merch

VISIT TombRaiderSeattle.com FOR MORE INFO